

Addendum #1-1

LOT 2301
N/
JEFFERSON-CHOUTEAU PARTNERS, LLC
DATE: 5/2/07 DAILY NO. 334

LOT 2231
N/F
PAPIN PARTNERS, LLC
DATE: 7/28/03 DAILY NO. 147



PROJECT NORTH

LOCAL 36 SHEET METAL WORKERS UNION

2319 CHOUTEAU AVE.,
ST. LOUIS, MO 63103

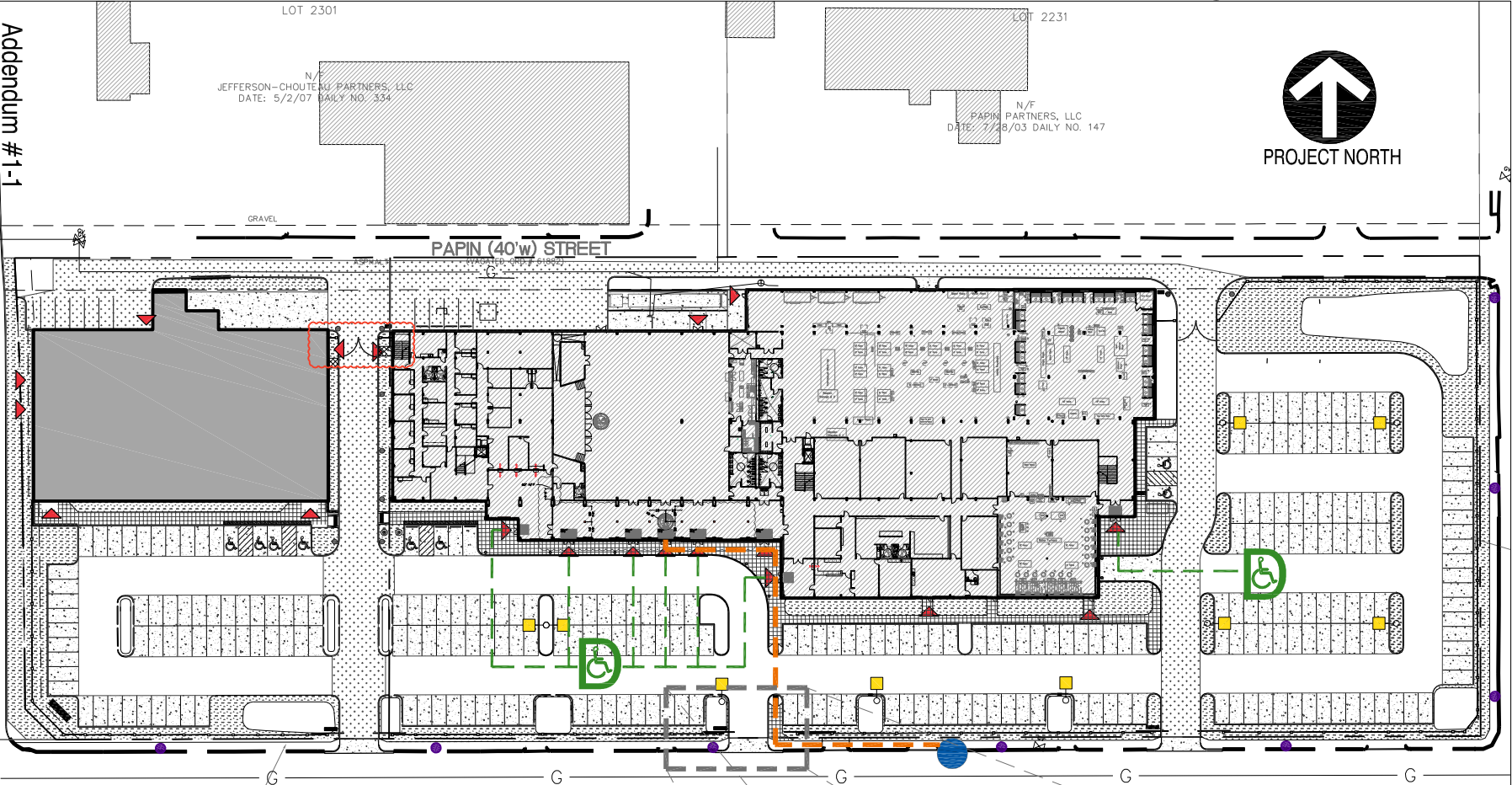

APPROXIMATE LOCATION OF UNDERGROUND ELECTRIC PER MARKS IN THE FIELD

LEGEND

-  PUBLIC BUS STOP
-  ACCESSIBLE PATH 307 FT FROM BUS STOP TO AN ACCESSIBLE DOOR
-  INDICATES ACCESSIBLE DOOR

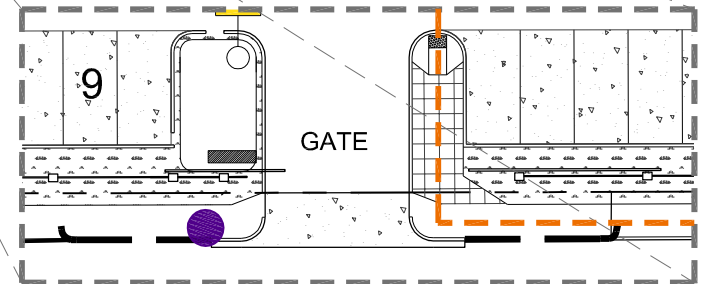

THE GATE WILL BE OPEN DURING BUSINESS/SCHOOL/EVENT HOURS. HANDICAP ACCESSIBLE ROUTE TO ACCESSIBLE DOORS FROM BUS STOP IS AVAILABLE DURING HOURS OF OPERATION.

Drawing
cover
Date 02.11.10
Project No. B50424.01